

## PRODUCTS TECHNICAL SHEET

### LED LAMPS

**H7 ZDLED701**

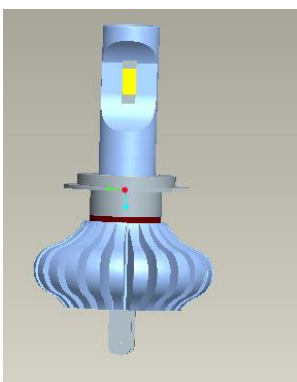
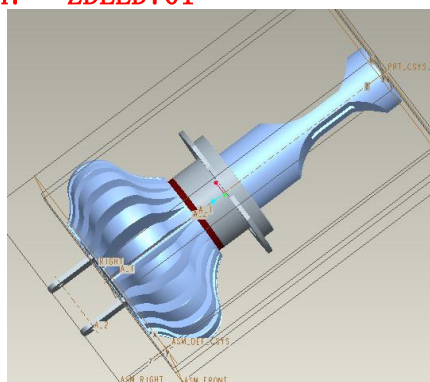

**H4 ZDLED401**

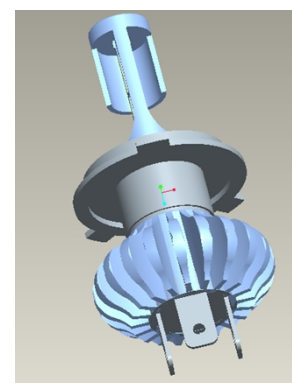
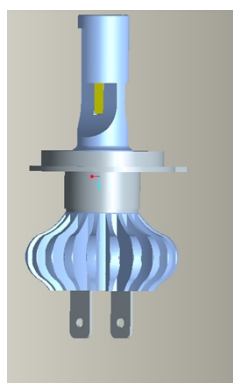
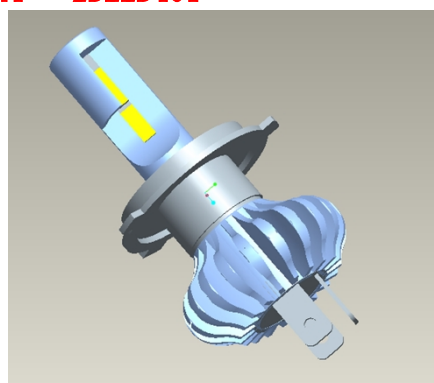

#### ADVANTAGE:

- Safe & same beam pattern as halogen bulbs.
- High efficiency, efficiency 110% plus.
- Far beam, it has more than 40m white light output, it can help the driver to find obstacles and dangers in time.
- High CRI, the color rendering index is more than 99%, it makes the object color more vivid.
- Driver inside the lamps, much more convenient for installation.
- Special heat radiation design, better heat radiation.
- UV free, Better protection of automobile lamps, improve the service life of lamps.

**FEATURES:** - Special design. Special blue color, in order to improve the performance.

## PRODUCTS TECHNICAL SHEET

### Technical Data

Description	Required Wattage(W)	Voltage (V)	Power (W)	Test Voltage (v)	The luminous flux & tolerance		Color Temperature (K)
					Luminous (lm)	Tolerance	
ZDLED701	14 W	12,0 V	12,00 W	13,2 V	1300 lm	±10 %	6000-6500
ZDLED401	15 W	12,0 V	13,00 W	13,2 V	1500 lm	±15 %	6000-6500

Descrição do produto	Lifetime		Base Type	Category ECE
	Lifetime B3	Lifetime Tc		
ZDLED701	10,000 h	40,000 h	PX26d	H7
ZDLED401	10,000 h	40,000 h	P43t	H4

# PRODUCTS TECHNICAL SHEET

---

## Beam Pattern

Minor of LED lamp



Minor of Halogen lamp

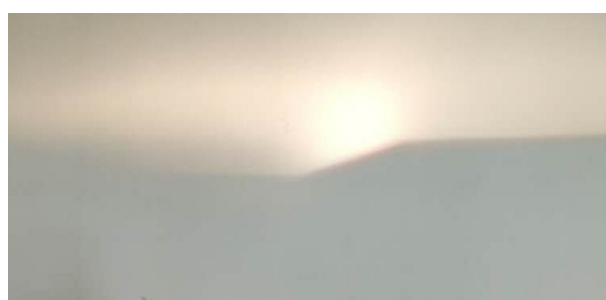

## Beam Pattern

Major of LED lamp

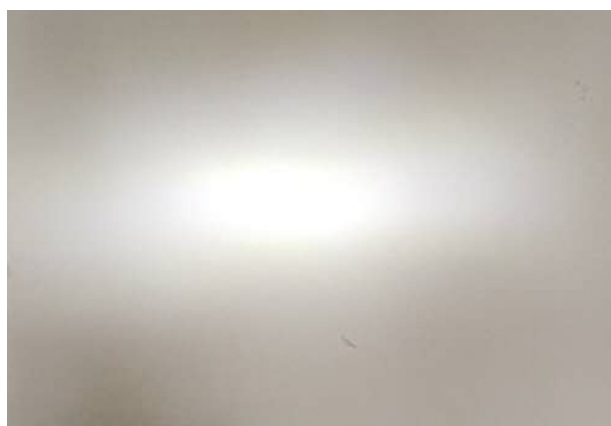

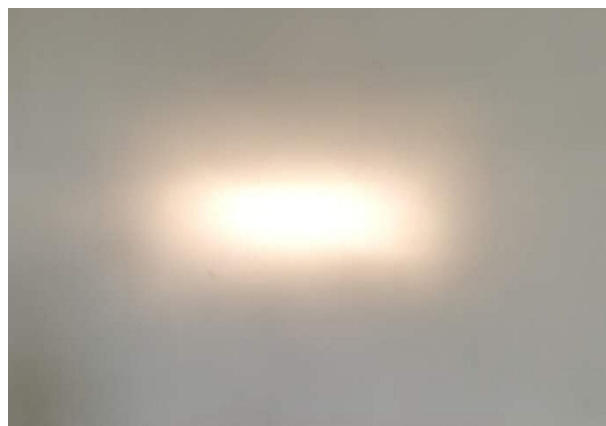

Major of Halogen lamp



## INSTRUCTIONS

---

Please follow below solutions to confirm the defective problems.

All in one lamp	 Flicking	Please connect suitable CANBUS decoder to solve the CANBUS problem.
	 Light Off	Please make sure of correct installation if the lamp body is still not work.
	 Abnormal Light	Please connect suitable CANBUS decoder to solve the CANBUS problem.

### Attention following conditions

1. CANBUS problem:When replace the original halogen bulb with LED bulb,some vehicles may meet with CANBUS problem like light flickering etc,please connect suitable decoder to solve the CANBUS problem.
2. Man-made reason:Man-made reason lead to broken LED chip,chapped wire,user modify or repair the bulb themselves etc.
3. Installation problem:Some vehicles may can not install out product because of small installation space or installation position doesn't fit etc.
4. Natural disaster:Damage because of irresistible natural disaster like earthquake,flood etc.