

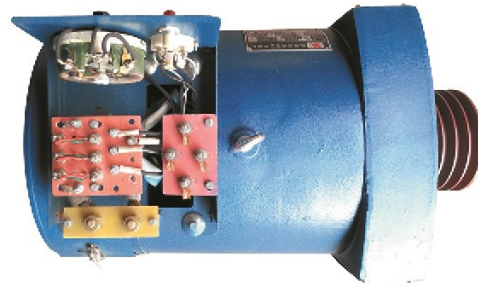

### SD/SDC 系列交流发电电焊两用机

SD/SDC series A.C generating electricity & welding double-duty generator



SD/SDC 系列发电电焊两用机适宜于内燃机配套组成移动或固定式电源，适用于城镇、乡村、林区、建筑工地、小型船舶等作为照明、日用电器；电动工具以及电焊的电源。本产品可发电、电焊单独使用，也可以少量照明和电焊同时使用。

SD/SDC series A.C generating electricity & welding double-duty generator is best driven by an internal combustion engine. They thus form a mobile or stationary power supply unit which is suited to be used in towns, countryside, forests, construction sites or on boats for lighting, household appliances, power tools and welding.

This machine can serve for either power generating or electric welding individually, and for both welding and a small scale illumination simultaneously.

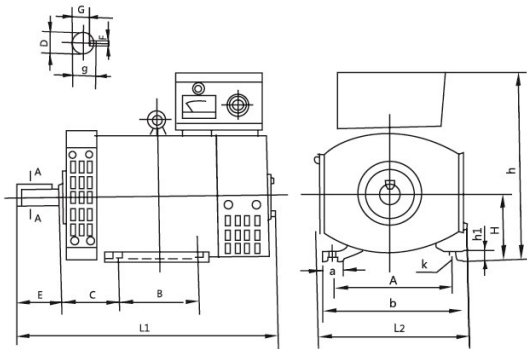

Power		Installing dimensions									External dimensions						
KVA	Kw	A	B	C	D	E	F	G	H	K	a	b	h1	h	L1	L2	g
6.3	5	254	254	108	φ38	80	10	33	160	15	50	310	25	455	580	325	40.8
9.4	7.5	254	254	108	φ38	80	10	33	160	15	50	310	25	455	580	325	40.8
12.5	10	279	203	121	φ42	110	12	37	180	15	60	339	25	495	610	365	44.8
15	12	279	203	121	φ42	110	12	37	180	15	60	339	25	495	610	365	44.8
18.8	15	318	228	133	φ42	110	14	42.5	200	19	60	378	30	540	660	400	51.2
25	20	318	228	133	φ48	110	14	42.5	200	19	60	378	30	540	660	400	51.2

#### 技术参数 Technical Data

型号 Type	三相 400V 50Hz/1500r/min cosφ=0.8							
	额定功率 Rated Power		额定电压 Rated Voltage (V)	额定电流 Rated current (A)	电焊空载电压 Welding voltage under no load (V)	焊接电流 Welding current (A)	暂载率 Continuous rate under load (%)	电焊电流调节范围 Current adjustment range for welding (A)
	KW	KVA						
SDC-5	5	6.3	400	9	<80	140	40	60-160
SDC-8	8	10	400	13.5	<80	180	40	70-200
SDC-10	10	12.5	400	18.1	<80	200	40	80-280
SDC-12	12	15	400	21.7	<80	250	40	100-300
SDC-15	15	18.75	400	27.1	<80	300	40	100-350