

wilda

Machine Tool Accessories

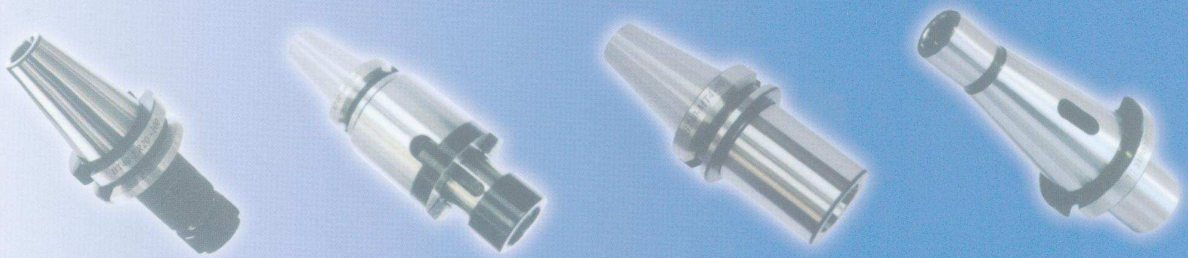

Weifang Wilda Machinery Co.,Ltd.

BT/MTA数控莫氏变径套 (扁尾型)

BT/MTA ADAPTER (WITH TANG)

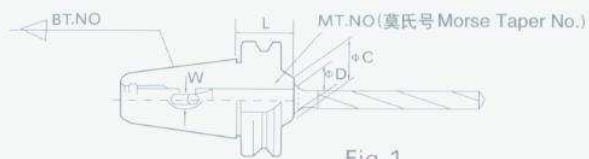

Fig 1

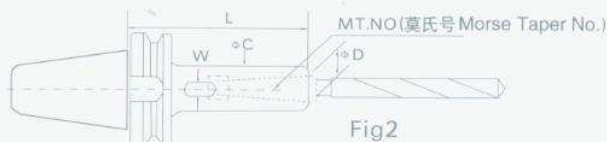
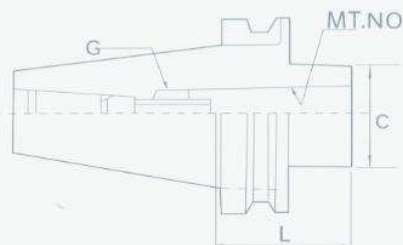

Fig2

单位/Unit:mm

| 型号 Model | BT.NO-MT.NO-L | MT.NO. | D | L | C | W | Fig | 重量Wt(Kg) |
|---------------|---------------|--------|--------|-----|----|------|-----|----------|
| BT30-MTA1-45 | BT30-MTA1-45 | 1 | 12.065 | 45 | 20 | 5.6 | 1 | 0.8 |
| BT30-MTA1-105 | | | | 105 | 25 | | 2 | 0.9 |
| BT30-MTA2-60 | BT30-MTA2-60 | 2 | 17.780 | 60 | 30 | 6.6 | 1 | 0.9 |
| BT30-MTA2-120 | | | | 120 | | | 2 | 1.2 |
| BT30-MTA3-80 | BT30-MTA3-80 | 3 | 23.825 | 80 | 40 | 8.4 | 1 | 1.0 |
| BT40-MTA1-45 | BT40-MTA1-45 | 1 | 12.065 | 45 | 25 | 5.6 | 1 | 1.0 |
| BT40-MTA1-120 | | | | 120 | | | 2 | 1.3 |
| BT40-MTA2-60 | BT40-MTA2-60 | 2 | 17.780 | 60 | 32 | 6.6 | 1 | 1.4 |
| BT40-MTA2-120 | | | | 120 | | | 1 | 1.4 |
| BT40-MTA3-75 | BT40-MTA3-75 | 3 | 23.265 | 75 | 40 | 8.4 | 1 | 1.2 |
| BT40-MTA3-135 | | | | 135 | | | 2 | 1.8 |
| BT40-MTA4-95 | BT40-MTA4-95 | 4 | 31.267 | 95 | 50 | 12.4 | 1 | 1.4 |
| BT40-MTA4-165 | | | | 165 | | | 2 | 2.4 |
| BT50-MTA1-45 | BT50-MTA1-45 | 1 | 12.065 | 45 | 25 | 5.6 | 1 | 4.0 |
| BT50-MTA1-120 | | | | 120 | | | 2 | 4.3 |
| BT50-MTA1-180 | | | | 180 | | | | 4.3 |
| BT50-MTA2-45 | BT50-MTA2-45 | 2 | 17.780 | 45 | 32 | 6.6 | 1 | 4.0 |
| BT50-MTA2-135 | | | | 135 | | | 2 | 4.4 |
| BT50-MTA2-180 | | | | 180 | | | | 4.6 |
| BT50-MTA3-45 | BT50-MTA3-45 | 3 | 23.265 | 45 | 40 | 8.4 | 1 | 3.9 |
| BT50-MTA3-150 | | | | 150 | | | 2 | 4.7 |
| BT50-MTA3-180 | | | | 180 | | | | 4.9 |
| BT50-MTA4-75 | BT50-MTA4-75 | 4 | 31.267 | 75 | 50 | 12.4 | 1 | 4.0 |
| BT50-MTA4-180 | | | | 180 | | | 2 | 5.4 |
| BT50-MTA5-105 | BT50-MTA5-105 | 5 | 44.399 | 105 | 65 | 16.5 | 1 | 4.6 |

BT/MTB 数控莫氏变径套 (螺丝锁紧)
BT/MTB ADAPTER (SCREW LOCK)



单位/Unit:mm

| 型号 Model | BT.NO X MT.NO-L | 莫氏锥度MT.NO | L | C | G | 适用铣刀/End Mill Type |
|-----------------|-----------------|-----------|-----|----|-----|--------------------|
| BT30 X MTB1-45 | | 1 | 45 | 25 | M6 | Φ 10 Φ 14 |
| BT40 X MTB2-60 | | 2 | 60 | 32 | M10 | Φ 16 Φ 12 |
| BT40 X MTB1-45 | | 1 | 45 | 25 | M6 | Φ 10 Φ 14 |
| BT40 X MTB2-60 | | 2 | 60 | 32 | M10 | Φ 15 Φ 22 |
| BT40 X MTB3-75 | | 3 | 75 | 40 | M12 | Φ 24 Φ 32 |
| BT40 X MTB4-75 | | 4 | 75 | 48 | M16 | Φ 32 Φ 50 |
| BT50 X MTB1-45 | | 1 | 45 | 25 | M6 | Φ 10 Φ 14 |
| BT50 X MTB2-45 | | 2 | 45 | 32 | M10 | Φ 16 Φ 22 |
| BT50 X MTB3-60 | | 3 | 60 | 40 | M12 | Φ 24 Φ 32 |
| BT50 X MTB4-75 | | 4 | 75 | 50 | M16 | Φ 55 Φ 60 |
| BT50 X MTB5-120 | | 5 | 120 | 70 | M24 | Φ 40 Φ 60 |

7:24变径套 (拉杆型)
7:24 ADAPTER (DRAW BAR)

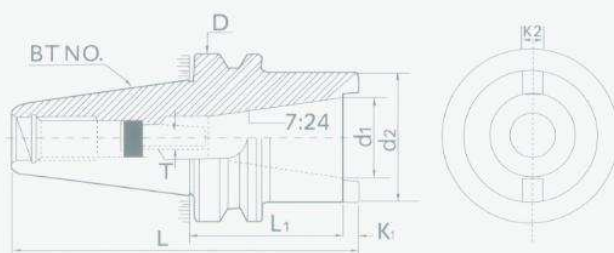

单位/Unit:mm

| 型号 Model | BT.NO X TSA.NO-L1 | L | L1 | D | d2 | K1 | K2 | T | 重量Wt(Kg) |
|------------------|-------------------|-------|----|-----|----|----|------------|-------------|----------|
| BT40 X TSA30M-75 | | 146.4 | 75 | 63 | 50 | 6 | 16 | M1 X 1.75P | 1.8 |
| BT40 X TSA30U-75 | | | | | | | | 1/2" W12 | 1.8 |
| BT50 X TSA30M-75 | | 182.8 | | 100 | 85 | 8 | | M12 X 1.75P | 5.0 |
| BT50 X TSA30U-75 | | | | | | | | 1/2" W12 | 5.0 |
| BT50 X TSA40M-75 | | 184.8 | | | | | M16 X 2.0P | 4.6 | |
| BT40 X TSA40U-75 | | | | | | | 5/8" W11 | 4.6 | |

7:24/MS 变径套 (开尾式)
7:24/MS ADAPTER (END OPENING TYPE)

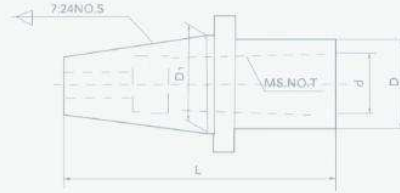

单位/Unit:mm

| 型号Model 7:24NO.S-MS.NO.T | D | D1 | d | L | 重量Wt(Kg) |
|-----------------------------|----|-------|--------|-----|----------|
| 30-1 | 24 | 31.75 | 12.065 | 75 | 0.64 |
| 30-2 | 30 | 31.75 | 17.780 | 100 | 0.72 |
| 30-3 | 36 | 31.75 | 23.825 | 130 | 0.80 |
| 30-4 | 48 | 31.75 | 31.267 | 165 | 3.00 |
| 40-1 | 24 | 44.45 | 12.065 | 80 | 0.80 |
| 40-2 | 30 | 44.45 | 17.780 | 85 | 0.83 |
| 40-3 | 36 | 44.45 | 23.825 | 100 | 0.88 |
| 40-4 | 48 | 44.45 | 31.267 | 145 | 2.90 |
| 40-5 | 61 | 44.45 | 44.399 | 225 | 2.92 |
| 50-1 | 25 | 69.85 | 12.065 | 127 | 3.00 |
| 50-2 | 32 | 69.85 | 17.780 | 127 | 2.94 |
| 50-3 | 40 | 69.85 | 23.825 | 127 | 2.58 |
| 50-4 | 48 | 69.85 | 31.267 | 127 | 2.62 |
| 50-5 | 61 | 69.85 | 44.399 | 180 | 3.20 |

7:24/MS 变径套 (拉杆型)
7:24/MS ADAPTER (DRAW BAR TYPE)

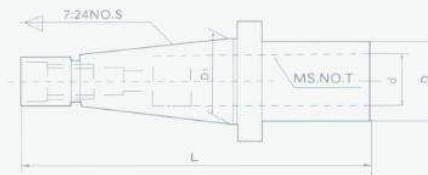

单位/Unit:mm

| 型号Model 7:24NO.S-MTB.NO.T | D | D1 | d | L | 重量Wt(Kg) |
|------------------------------|----|-------|--------|-----|----------|
| 30-MTB1 | 25 | 31.75 | 12.065 | 118 | |
| 40-MTB1 | 25 | 44.45 | 12.065 | 143 | |
| 50-MTB1 | 25 | 69.85 | 12.065 | 160 | 3.00 |
| 50-MTB2 | 32 | 69.85 | 17.780 | 160 | 2.94 |
| 50-MTB3 | 40 | 69.85 | 23.825 | 160 | 2.58 |
| 50-MTB4 | 48 | 69.85 | 31.267 | 180 | 2.62 |
| 50-MTB5 | 61 | 69.85 | 44.399 | 210 | 3.20 |

7:24/MS 变径套 (扁尾型)
7:24/MS ADAPTER (WITH TANG)

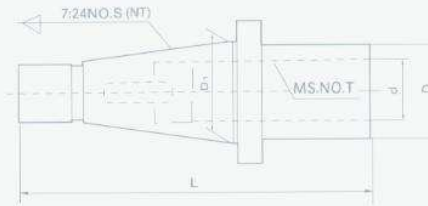

单位/Unit:mm

| 型号Model 7:24NO.S-MS.NO.T | 7:24 NO.S | MTA.NO.T | D | D1 | d | L |
|-----------------------------|-----------|----------|----|-------|--------|-----|
| 30-MS1 | ISO30 | MTA1 | 25 | 31.75 | 12.065 | 118 |
| 30-MS2 | | MTA2 | 32 | | 17.780 | 118 |
| 30-MS3 | | MTA3 | 40 | | 23.825 | 138 |
| 30-MS4 | | MTA4 | 48 | | 31.267 | 212 |
| 40-MS1 | ISO40 | MTA1 | 25 | 44.45 | 12.065 | 143 |
| 40-MS2 | | MTA2 | 32 | | 17.780 | 143 |
| 40-MS3 | | MTA3 | 40 | | 23.825 | 158 |
| 40-MS4 | | MTA4 | 48 | | 31.267 | 188 |
| 40-MS5 | | MTA5 | 61 | | 44.399 | 232 |
| 50-MS1 | ISO50 | MTA1 | 25 | 69.85 | 12.065 | 172 |
| 50-MS2 | | MTA2 | 32 | | 17.780 | 187 |
| 50-MS3 | | MTA3 | 40 | | 23.825 | 192 |
| 50-MS4 | | MTA4 | 48 | | 31.267 | 197 |
| 50-MS5 | | MTA5 | 61 | | 44.399 | 273 |

BT/EOC 立铣刀夹头
BT/EOC MILLING CHUCK

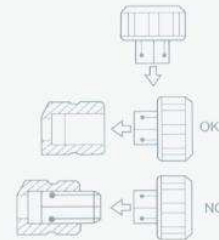
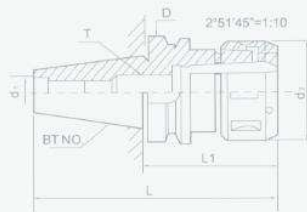

单位/Unit:mm

| 型号Model | BT NO.X EOC NO-L1 | L | L1 | D | d1 | d2 | T | 重量Wt(Kg) |
|----------------|-------------------|-------|-----|-----|------|----|-------------|----------|
| BT30XEOC25-70 | | 118.4 | 70 | 46 | 12.5 | 60 | M12 X 1.75P | 1.00 |
| BT40XEOC25-70 | | 135.4 | 70 | 63 | 17.0 | 60 | M16 X 2.0P | 1.65 |
| BT40XEOC25-100 | | 165.4 | 100 | 63 | 17.0 | 60 | | 2.25 |
| BT40XEOC25-120 | | 185.4 | 120 | 63 | 17.0 | 60 | M20 X 2.0P | 2.70 |
| BT40XEOC32-90 | | 155.4 | 90 | 63 | 17.0 | 72 | | 2.00 |
| BT40XEOC32-105 | | 170.4 | 105 | 63 | 17.0 | 72 | | 2.20 |
| BT40XEOC32-120 | | 185.4 | 120 | 63 | 17.0 | 72 | M16 X 2.0P | 2.45 |
| BT50XEOC25-85 | | 186.8 | 85 | 100 | 25.0 | 60 | | 4.45 |
| BT50XEOC25-100 | | 201.8 | 100 | 100 | 25.0 | 60 | M16 X 2.0P | 4.48 |
| BT50XEOC25-120 | | 221.8 | 120 | 100 | 25.0 | 60 | | 5.20 |
| BT50XEOC32-90 | | 191.8 | 90 | 100 | 25.0 | 72 | M24 X 2.0P | 4.60 |
| BT50XEOC32-105 | | 206.3 | 105 | 100 | 25.0 | 72 | | 4.85 |
| BT50XEOC32-120 | | 221.8 | 120 | 100 | 25.0 | 72 | | 5.35 |

BT/MAS 立铣刀夹头 BT/MAS MILLING CHUCK



单位/Unit:mm

| 型号Model | BT NO. | ER NO. | -L1 | L1 | L | d1 | d2 | d3 | T |
|-----------------|--------|--------|-----|-----|-------|----|----|----|-------------|
| BT30 X ER16-70 | | | | 70 | 118.4 | 28 | 16 | 28 | M10 X 1.5P |
| BT30 X ER16-100 | | | | 100 | 148.4 | | | 28 | |
| BT30 X ER16-120 | | | | 120 | 168.4 | | | 28 | |
| BT30 X ER20-70 | | | | 70 | 118.4 | 34 | 20 | 34 | M12 X 1.75P |
| BT30 X ER20-100 | | | | 100 | 148.4 | | | 34 | |
| BT30 X ER20-135 | | | | 135 | 183.4 | | | 32 | |
| BT30 X ER25-70 | | | | 70 | 118.4 | 42 | 25 | 42 | M16 X 2.0P |
| BT30 X ER25-135 | | | | 135 | 183.4 | | | 42 | |
| BT30 X ER32-70 | | | | 70 | 118.4 | | | 50 | |
| BT30 X ER32-100 | | | | 100 | 148.4 | 50 | 32 | 45 | M16 X 2.0P |
| BT30 X ER40-80 | | | | 80 | 128.4 | 63 | 40 | 53 | M16 X 2.0P |
| BT40 X ER16-70 | | | | 70 | 135.4 | 28 | 16 | 28 | M10 X 1.5P |
| BT40 X ER16-100 | | | | 100 | 165.4 | | | 28 | |
| BT40 X ER16-125 | | | | 125 | 190.4 | | | 28 | |
| BT40 X ER16-150 | | | | 150 | 215.4 | | | 28 | |
| BT40 X ER20-70 | | | | 70 | 135.4 | 34 | 20 | 34 | M12 X 1.75P |
| BT40 X ER20-100 | | | | 100 | 170.4 | | | 34 | |
| BT40 X ER20-135 | | | | 135 | 200.4 | | | 34 | |
| BT40 X ER20-150 | | | | 150 | 215.4 | | | 34 | |
| BT40 X ER25-70 | | | | 70 | 135.4 | 42 | 25 | 42 | M16 X 2.0P |
| BT40 X ER25-90 | | | | 90 | 155.4 | | | 42 | |
| BT40 X ER25-125 | | | | 125 | 190.4 | | | 42 | |
| BT40 X ER25-150 | | | | 150 | 215.4 | | | 42 | |
| BT40 X ER32-70 | | | | 70 | 135.4 | 50 | 32 | 50 | M16 X 2.0P |
| BT40 X ER32-100 | | | | 100 | 165.4 | | | 50 | |
| BT40 X ER32-150 | | | | 150 | 215.4 | | | 52 | |
| BT40 X ER40-80 | | | | 80 | 145.4 | 63 | 40 | 63 | M20 X 2.0P |
| BT40 X ER40-100 | | | | 100 | 165.4 | | | 63 | |
| BT40 X ER40-120 | | | | 120 | 185.4 | | | 63 | |
| BT40 X ER40-150 | | | | 150 | 215.4 | | | 63 | |
| BT40 X ER50-85 | | | | 85 | 145.4 | 78 | 50 | 59 | M24 X 2.0P |
| BT40 X ER50-100 | | | | 100 | 165.4 | | | 59 | |

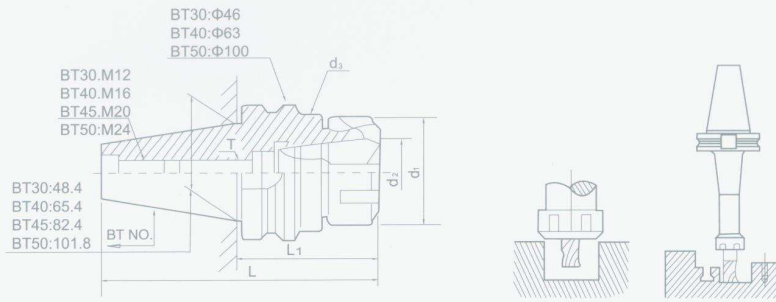

单位/Unit:mm

| 型号Model BT NO.X ER NO.-L1 | L1 | L | d1 | d2 | d3 | T |
|---------------------------|-----|-------|----|----|----|-------------|
| BT50 X ER16-70 | 70 | 171.8 | 28 | 16 | 28 | M10 X 1.5P |
| BT50 X ER16-90 | 90 | 191.8 | | | | |
| BT50 X ER16-105 | 105 | 206.8 | | | | |
| BT50 X ER16-135 | 135 | 236.8 | | | | |
| BT50 X ER16-165 | 165 | 266.8 | | | | |
| BT50 X ER20-70 | 70 | 171.8 | 34 | 20 | 34 | M12 X 1.75P |
| BT50 X ER20-90 | 90 | 191.8 | | | | |
| BT50 X ER20-105 | 105 | 206.8 | | | | |
| BT50 X ER20-135 | 135 | 236.8 | | | | |
| BT50 X ER20-150 | 150 | 251.8 | | | | |
| BT50 X ER20-165 | 165 | 266.8 | | | | |
| BT50 X ER20-200 | 200 | 301 | 45 | 25 | 42 | M16 X 2.0P |
| BT50 X ER25-70 | 70 | 171.8 | | | | |
| BT50 X ER25-105 | 105 | 206.8 | | | | |
| BT50 X ER25-135 | 135 | 236.8 | | | | |
| BT50 X ER25-165 | 165 | 266.8 | | | | |
| BT50 X ER32-80 | 80 | 181.8 | 50 | 32 | 50 | M16 X 2.0P |
| BT50 X ER32-100 | 100 | 201.8 | | | | |
| BT50 X ER32-120 | 120 | 221.8 | | | | |
| BT50 X ER32-150 | 150 | 251 | | | | |
| BT50 X ER32-200 | 200 | 301 | | | | |
| BT50 X ER40-80 | 80 | 181.8 | 63 | 40 | 63 | M20 X 2.0P |
| BT50 X ER40-100 | 100 | 201.8 | | | | |
| BT50 X ER40-120 | 120 | 221.8 | | | | |
| BT50 X ER40-135 | 135 | 236.8 | | | | |
| BT50 X ER50-90 | 90 | 191.8 | 78 | 50 | 78 | M24 X 2.0P |
| BT50 X ER50-120 | 120 | 221.8 | | | | |
| BT50 X ER50-165 | 165 | 266.8 | | | | |
| BT50 X ER16-70 | 70 | 142 | 28 | 16 | 28 | M12 X 1.5P |
| BT50 X ER16-100 | 100 | 172 | | | | |
| BT45 X ER16-150 | 150 | 222 | | | | |
| BT45 X ER32-80 | 80 | 150 | 50 | 32 | 50 | M22 X 1.75P |
| BT45 X ER32-120 | 120 | 190 | | | | |
| BT45 X ER40-80 | 80 | 148 | 63 | 40 | 63 | M22 X 1.5P |
| BT45 X ER40-120 | 120 | 188 | | | | |
| BT45 X ER50-100 | 100 | 161 | 78 | 50 | 78 | M22 X 1.5P |

BT/TG 超强力立铣刀夹头 BT/TG SUPPER POWER MILLING CHUCK

单位/Unit:mm

| d1 TEST BAR | | L | 同心度 Concentricity |
|-------------|-----------|----|----------------------|
| Min. Dia. | Max. Dia. | | |
| 3 | 6 | 16 | 0.01 |
| 6 | 10 | 25 | |
| 10 | 18 | 40 | |
| 18 | 24 | 50 | 0.01 |
| 24 | 32 | 60 | |

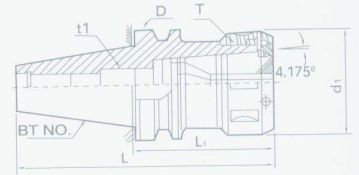
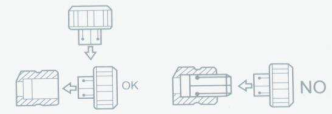

单位/Unit:mm

| 型号Model | BT NO. | TG NO.-L1 | L | L1 | D | d1 | t1 | T | 重量Wt(Kg) |
|------------------|--------|-----------|-------|-----|-----|----|------------|-------------|----------|
| BT30 X TG75-70 | | | 118.4 | 70 | 46 | 50 | M16 X 2.0P | TW1-1/2"-12 | 1.10 |
| BT30 X TG75-100 | | | 148.4 | 100 | | | | TW1-7/8"-12 | 1.15 |
| BT30 X TG100-100 | | | 148.4 | 100 | 63 | 60 | M24 X 2.0P | TW1-7/8"-12 | 1.20 |
| BT40 X TG100-70 | | | 135.4 | 70 | | | | TW1-7/8"-12 | 1.20 |
| BT40 X TG100-100 | | | 165.4 | 100 | | | | TW2-5/8"-12 | 1.30 |
| BT40 X TG100-120 | | | 185.4 | 120 | | | | TW2-5/8"-12 | 2.40 |
| BT40 X TG150-150 | | | 170.4 | 150 | | | | TW2-5/8"-12 | 2.70 |
| BT40 X TG150-120 | | | 185.4 | 120 | | | | TW2-5/8"-12 | 2.90 |
| BT40 X TG150-135 | | | 200.4 | 135 | 100 | 82 | M24 X 2.0P | TW2-5/8"-12 | 3.20 |
| BT50 X TG100-85 | | | 186.8 | 85 | | | | TW2-5/8"-12 | 3.40 |
| BT50 X TG100-100 | | | 201.8 | 100 | | | | TW2-5/8"-12 | 4.40 |
| BT50 X TG100-120 | | | 221.8 | 120 | | | | TW2-5/8"-12 | 5.10 |
| BT50 X TG150-90 | | | 191.8 | 90 | | | | TW2-5/8"-12 | 5.70 |
| BT50 X TG150-105 | | | 206.8 | 105 | | | | TW2-5/8"-12 | 6.10 |
| BT50 X TG150-120 | | | 221.8 | 120 | | | | TW2-5/8"-12 | 6.50 |

MAS 403-1982拉钉 RETENTION KNOB

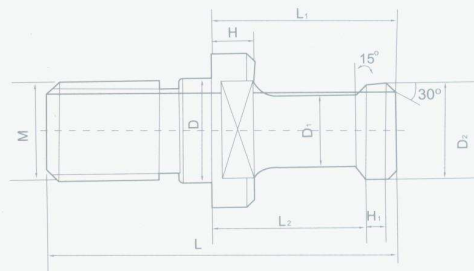

单位/Unit:mm

| 型号Model | D | D1 | D2 | M | L | L1 | L2 | H | H1 | θ | |
|------------|------|----|----|-----|----|----|----|----|-----|-----|-----|
| LD-BT30(θ) | 12.5 | 7 | 11 | M12 | 43 | 23 | 18 | 5 | 2.5 | 30° | 45° |
| LD-BT40(θ) | 17 | 10 | 15 | M16 | 60 | 35 | 28 | 6 | 3 | 30° | 45° |
| LD-BT45(θ) | 21 | 14 | 19 | M20 | 70 | 40 | 31 | 8 | 4 | 30° | 45° |
| LD-BT50(θ) | 25 | 17 | 23 | M24 | 85 | 45 | 35 | 10 | 5 | 30° | 45° |

数控混合插入式铣刀杆
COMBI SHELL END MILL ARBOR

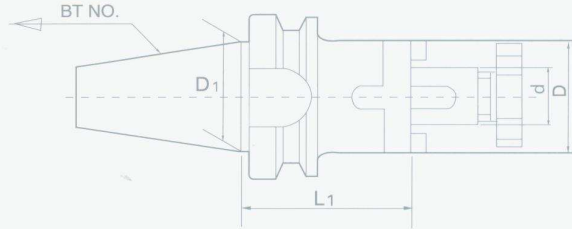

单位/Unit:mm

| 型号Model | BT NO. X d-L1 | D | D1 | 重量Wt(Kg) |
|---------|---------------|----|-------|----------|
| | BT30 X 13-55 | 28 | 31.75 | 1.00 |
| | BT30 X 16-55 | 32 | 31.75 | 1.00 |
| | BT30 X 16-100 | 32 | 31.75 | 1.20 |
| | BT30 X 22-55 | 40 | 31.75 | 1.20 |
| | BT30 X 22-100 | 40 | 31.75 | 1.40 |
| | BT30 X 27-55 | 48 | 31.75 | 1.20 |
| | BT30 X 27-100 | 48 | 31.75 | 2.00 |
| | BT30 X 32-60 | 58 | 31.75 | 1.50 |
| | BT30 X 32-100 | 58 | 31.75 | 2.60 |
| | BT30 X 40-60 | 70 | 31.75 | 2.30 |
| | BT30 X 40-100 | 70 | 31.75 | 3.50 |
| | BT40 X 13-55 | 28 | 44.45 | 1.00 |
| | BT40 X 16-55 | 32 | 44.45 | 1.20 |
| | BT40 X 16-100 | 32 | 44.45 | 1.50 |
| | BT40 X 22-55 | 40 | 44.45 | 1.25 |
| | BT40 X 22-100 | 40 | 44.45 | 1.85 |
| | BT40 X 27-55 | 48 | 44.45 | 1.50 |
| | BT40 X 27-100 | 48 | 44.45 | 2.00 |
| | BT40 X 32-60 | 58 | 44.45 | 1.50 |
| | BT40 X 32-100 | 58 | 44.45 | 2.30 |
| | BT40 X 40-60 | 70 | 44.45 | 2.00 |
| | BT40 X 40-100 | 70 | 44.45 | 3.00 |
| | BT50 X 13-63 | 28 | 69.85 | 3.50 |
| | BT50 X 16-63 | 32 | 69.85 | 3.60 |
| | BT50 X 16-100 | 32 | 69.85 | 4.00 |
| | BT50 X 22-70 | 40 | 69.85 | 3.70 |
| | BT50 X 22-100 | 40 | 69.85 | 4.00 |
| | BT50 X 27-70 | 48 | 69.85 | 4.00 |
| | BT50 X 27-100 | 48 | 69.85 | 4.40 |
| | BT50 X 32-70 | 58 | 69.85 | 4.20 |
| | BT50 X 32-100 | 58 | 69.85 | 4.70 |
| | BT50 X 40-75 | 70 | 69.85 | 4.50 |
| | BT50 X 40-100 | 70 | 69.85 | 5.50 |
| | BT50 X 50-75 | 90 | 69.85 | 4.60 |
| | BT50 X 50-125 | 90 | 69.85 | 7.20 |

数控钻接杆 DRILL CHUCK ARBOR

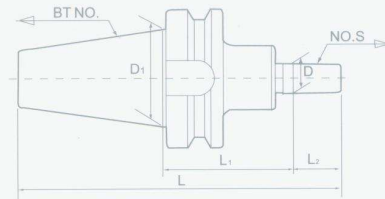

单位/Unit:mm

| 型号Model BT NO.-NO.S-L1 | L2 | L | D | D1 | 拉杆 Draw Bar | 重量 Wt(kg) |
|---------------------------|--------|-------|--------|-------|----------------|-----------|
| BT30-J1-45 | 16.669 | 110 | 9.754 | 31.75 | M12 | 0.60 |
| BT30-J2-45 | 22.225 | 115.6 | 14.199 | 31.75 | M12 | 0.70 |
| BT30-J2S-45 | 19.05 | 112.4 | 14.94 | 31.75 | M12 | 0.70 |
| BT30-J3-45 | 30.956 | 124.4 | 20.599 | 31.75 | M12 | 0.80 |
| BT30-J4-45 | 42.069 | 135.4 | 28.550 | 31.75 | M12 | 0.85 |
| BT30-J5-45 | 47.625 | 141 | 35.890 | 31.75 | M12 | 0.90 |
| BT30-J6-45 | 25.4 | 118.8 | 17.170 | 31.75 | M12 | 0.75 |
| BT30-J33-45 | 25.4 | 113.8 | 15.850 | 31.75 | M12 | 0.75 |
| BT30-J10-45 | 14.5 | 107.9 | 10.094 | 31.75 | M12 | 2.40 |
| BT30-J12-45 | 18.5 | 111.9 | 12.065 | 31.75 | M12 | 0.60 |
| BT30-J16-45 | 24 | 117.4 | 15.733 | 31.75 | M12 | 0.70 |
| BT30-J18-45 | 32 | 125.4 | 17.780 | 31.75 | M12 | 0.82 |
| BT40-J1-45 | 16.669 | 127.1 | 9.754 | 44.45 | M16 | 1.15 |
| BT40-J2-45 | 22.225 | 132.6 | 14.199 | 44.45 | M16 | 1.25 |
| BT40-J2S-45 | 19.05 | 129.4 | 13.940 | 44.45 | M16 | 1.20 |
| BT40-J3-45 | 30.956 | 141.4 | 20.599 | 44.45 | M16 | 1.45 |
| BT40-J4-45 | 42.069 | 152.5 | 28.550 | 44.45 | M16 | 1.55 |
| BT40-J5-45 | 47.625 | 158 | 35.890 | 44.45 | M16 | 1.60 |
| BT40-J6-45 | 25.4 | 135.8 | 17.170 | 44.45 | M16 | 1.30 |
| BT40-J33-45 | 25.4 | 135.8 | 15.850 | 44.45 | M16 | 1.30 |
| BT40-J10-45 | 14.5 | 124.9 | 10.094 | 44.45 | M16 | 1.40 |
| BT40-J10-120 | 14.5 | 199.9 | 10.094 | 44.45 | M16 | 1.76 |
| BT40-B12-45 | 18.5 | 128.9 | 12.065 | 44.45 | M16 | 1.34 |
| BT40-B16-32 | 24 | 121.4 | 15.733 | 44.45 | M16 | 1.40 |
| BT40-B16-45 | 24 | 134.4 | 15.733 | 44.45 | M16 | 1.45 |
| BT40-B16-75 | 24 | 164.4 | 15.733 | 44.45 | M16 | 1.55 |
| BT40-B16-90 | 24 | 179.4 | 15.733 | 44.45 | M16 | 1.60 |
| BT40-B18-45 | 32 | 142.4 | 17.780 | 44.45 | M16 | 1.70 |
| BT40-B18-75 | 32 | 172.4 | 17.780 | 44.45 | M16 | 1.76 |
| BT45-B16-90 | 24 | 196.8 | 15.733 | 51.75 | M20 | 2.30 |
| BT45-B16-100 | 24 | 206.8 | 15.733 | 51.75 | M20 | 2.40 |
| BT50-J1-45 | 16.669 | 163.5 | 9.754 | 69.85 | M24 | 3.60 |
| BT50-J2-45 | 22.225 | 169 | 14.199 | 69.85 | M24 | 3.95 |

单位/Unit:mm

| 型号 Model BT NO.-NO.S-L1 | L2 | L | D | D1 | 拉杆 Draw Bar | 重量 Wt(kg) |
|----------------------------|--------|-------|--------|-------|-------------|-----------|
| BT50-J2S-45 | 19.05 | 165.9 | 13.940 | 69.85 | M24 | 3.90 |
| BT50-J3-45 | 30.956 | 177.8 | 20.599 | 69.85 | M24 | 3.70 |
| BT50-J4-45 | 42.069 | 188.9 | 28.500 | 69.85 | M24 | 3.75 |
| BT50-J5-45 | 47.625 | 194.4 | 35.890 | 69.85 | M24 | 3.80 |
| BT50-J6-45 | 25.4 | 172.2 | 17.170 | 69.85 | M24 | 4.00 |
| BT50-J33-45 | 25.4 | 172.2 | 15.850 | 69.85 | M24 | 4.00 |
| BT50-B10-45 | 14.5 | 161.3 | 10.094 | 69.85 | M24 | 3.60 |
| BT50-B10-100 | 14.5 | 216.3 | 10.094 | 69.85 | M24 | 3.80 |
| BT50-B12-45 | 18.5 | 165.3 | 12.065 | 69.85 | M24 | 3.60 |
| BT50-B16-45 | 24 | 170.8 | 15.733 | 69.85 | M24 | 3.65 |
| BT50-B16-60 | 24 | 185.8 | 15.733 | 69.85 | M24 | 3.70 |
| BT50-B16-75 | 24 | 200.8 | 15.733 | 69.85 | M24 | 3.74 |
| BT50-B16-90 | 24 | 215.8 | 15.733 | 69.85 | M24 | 3.78 |
| BT50-B18-45 | 32 | 178.8 | 17.780 | 69.85 | M24 | 3.70 |

数控立铣刀杆 A型 END MILL ADAPTER TYPE A

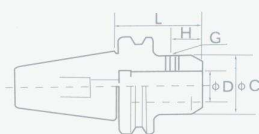

Fig 1

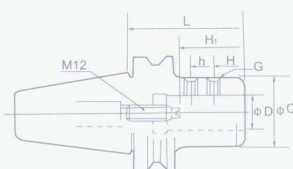
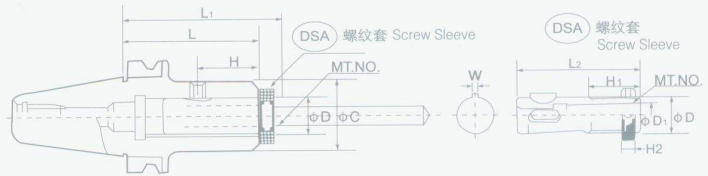
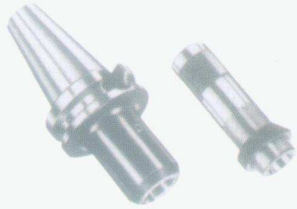

Fig2

单位/Unit:mm

| 型号 Model BT.NO.-D-L | D | L60 | C | H | h | H ₁ | G | Fig | 重量 Wt(kg) |
|------------------------|----|-----|----|------|----|----------------|----------|-----|-----------|
| BT30-6-60 | 6 | 60 | 20 | 15 | - | - | M6 | 1 | 1.2 |
| BT30-8-60 | 8 | 60 | 24 | 16 | - | - | M8 | 1 | 1.2 |
| BT30-10-60 | 10 | 60 | 32 | 6 | - | - | M8 | 1 | 1.2 |
| BT30-12-60 | 12 | 60 | 35 | 20 | - | - | M10 | 1 | 1.2 |
| BT30-16-60 | 16 | 60 | 40 | 22.5 | - | - | M10 | 1 | 1.2 |
| BT30-A20-75 | 20 | 75 | 50 | 24 | 15 | 55-70 | M14P=1.5 | 2 | 1.2 |
| BT40-6-65 | 6 | 65 | 20 | 15 | - | - | M6 | 1 | 1.6 |
| BT40-8-65 | 8 | 65 | 24 | 15 | - | - | M8 | 1 | 1.6 |
| BT40-10-65 | 10 | 65 | 30 | 16 | - | - | M8 | 1 | 1.6 |
| BT40-12-65 | 12 | 65 | 35 | 20 | - | - | M10 | 1 | 1.6 |
| BT40-16-65 | 16 | 65 | 40 | 23 | - | - | M10 | 1 | 1.7 |
| BT40-A20-90 | 20 | 90 | 50 | 24 | 21 | 55-70 | M14P=1.5 | 2 | 1.8 |
| BT40-A25-90 | 25 | 90 | 50 | 24 | 21 | 55-70 | M14P=1.5 | 2 | 1.7 |
| BT40-A32-90 | 32 | 90 | 60 | 25 | 25 | 55-70 | M16P=1.5 | 2 | 1.9 |
| BT50-6-75 | 6 | 75 | 20 | 15 | - | - | M6 | 1 | 4.3 |
| BT50-8-75 | 8 | 75 | 24 | 15 | - | - | M8 | 1 | 4.3 |
| BT50-10-75 | 10 | 75 | 30 | 16 | - | - | M8 | 1 | 4.3 |
| BT50-12-75 | 12 | 75 | 35 | 20 | - | - | M10 | 1 | 4.3 |
| BT50-16-75 | 16 | 75 | 40 | 23 | - | - | M10 | 1 | 4.5 |
| BT50-A20-105 | 20 | 105 | 50 | 24 | 21 | 55-70 | M14P=1.5 | 2 | 4.8 |
| BT50-A25-105 | 25 | 105 | 50 | 24 | 21 | 55-70 | M14P=1.5 | 2 | 4.7 |
| BT50-A32-105 | 32 | 105 | 60 | 25 | 25 | 65-80 | M16P=1.5 | 2 | 4.9 |
| BT50-A42-105 | 42 | 115 | 90 | 30 | 32 | 85-100 | M20P=2.0 | 2 | 6.6 |

数控立铣刀杆 B型 END MILL ADAPTER TYPE B



单位/Unit:mm

| 型号Model BT NO.-D-L | D | L | L1 | H | C | W | DSA 螺纹套 DSA Screw Sleeve | 重量Wt(kg) |
|--------------------|----|-----|---------|----|----|---|-----------------------------|----------|
| BT30-26-105 | 26 | 105 | 117-142 | 40 | 50 | 5 | DS26-MT1,MT2 | 1.4 1.5 |
| BT40-26-105 | 26 | 105 | 117-142 | 40 | 50 | 5 | DS26-MT1,MT2 | 1.7 2.5 |
| BT40-35-135 | 35 | 135 | 147-182 | 55 | 60 | 6 | DS26-MT1,MT3 | 2.4 3.0 |
| BT50-26-105 | 26 | 105 | 117-142 | 40 | 50 | 5 | DS26-MT1,MT2 | 1.8 4.7 |
| BT50-35-120 | 35 | 120 | 132-167 | 55 | 60 | 6 | DS26-MT1,MT3 | 5.6 5.5 |
| BT50-35-135 | 35 | 135 | 147-182 | 55 | 60 | 6 | | 6.4 6.0 |
| BT50-48-165 | 48 | 165 | 181-227 | 65 | 80 | 8 | DS48-MT3,MT4 | 8.4 8.1 |

数控套式铣刀杆 SHELL MILL ARBOR

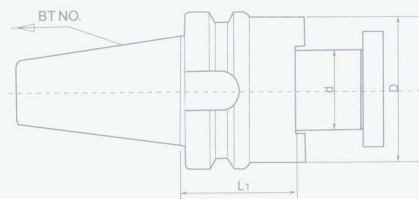

单位/Unit:mm

| 型号ModelBTXd-L1 | D | 重量 Wt(kg) | 型号ModelBTXd-L1 | D | 重量 Wt(kg) | 型号ModelBTXd-L1 | D | 重量 Wt(kg) |
|----------------|----|--------------|----------------|----|--------------|----------------|----|--------------|
| BT30X16-60 | 32 | 1.0 | BT40X27-120 | 48 | 2.3 | BT50X22-75 | 40 | 4.0 |
| BT30X22-60 | 40 | 1.3 | BT40X32-45 | 58 | 1.2 | BT50X22-100 | 40 | 4.5 |
| BT30X27-60 | 48 | 1.5 | BT40X32-60 | 58 | 1.5 | BT50X22-120 | 40 | 5.0 |
| BT30X32-60 | 58 | 1.8 | BT40X32-75 | 58 | 1.8 | BT50X27-60 | 48 | 5.5 |
| BT30X40-60 | 70 | 2.2 | BT40X32-120 | 58 | 2.8 | BT50X27-105 | 48 | 4.0 |
| BT30X50-70 | 90 | 4.5 | BT40X40-60 | 70 | 2.0 | BT50X32-60 | 58 | 4.5 |
| BT40X16-45 | 32 | 1.0 | BT40X40-75 | 70 | 2.2 | BT50X32-75 | 58 | 1.6 |
| BT40X16-60 | 32 | 1.3 | BT40X50-70 | 90 | 2.5 | BT50X32-105 | 58 | 1.8 |
| BT40X16-120 | 32 | 1.7 | BT45X22-60 | 40 | 2.6 | BT50X40-60 | 70 | 2.2 |
| BT40X22-45 | 40 | 1.5 | BT45X27-60 | 48 | 2.8 | BT50X40-75 | 70 | 3.6 |
| BT40X22-60 | 40 | 1.7 | BT45X27-100 | 48 | 3.1 | BT50X40-90 | 70 | 3.7 |
| BT40X22-100 | 40 | 3.0 | BT45X40-100 | 70 | 3.4 | BT50X40-100 | 70 | 3.75 |
| BT40X22-102 | 40 | 3.6 | BT45X40-105 | 70 | 3.5 | BT50X40-105 | 70 | 3.8 |
| BT40X27-45 | 48 | 1.5 | BT50X16-60 | 32 | 3.6 | BT50X50-60 | 90 | 4.0 |
| BT40X27-60 | 48 | 1.6 | BT50X16-75 | 32 | 3.9 | BT50X50-70 | 90 | 4.2 |
| BT40X27-75 | 48 | 1.8 | BT50X16-120 | 32 | 4.3 | BT50X50-120 | 90 | 4.4 |
| BT40X27-105 | 48 | 2.1 | BT50X22-60 | 40 | 5.0 | | | |

割槽刀柄

SIDE CUTTER ARBOR

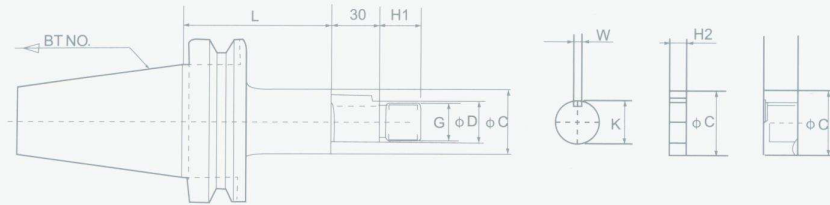

单位/Unit:mm

| 型号Model | BT.NO.-D-L | φD(h16) | L | φC | G | H ₁ | H ₂ | H ₃ | K | W | 重量Wt(kg) |
|-----------------|------------|---------|-----|----|----------|----------------|----------------|----------------|-------|-------|----------|
| BT40-12.7-60 | | 12.75 | 60 | 20 | M12X1.25 | 15 | 5 10 20 | 12 | - | - | 1.2 |
| BT40-15.875-75 | | 15.875 | 75 | 26 | M14X1.5 | 16 | | 13 | 17.42 | 3.18 | 1.4 |
| BT40-22.225-75 | | 22.225 | 75 | 34 | M20X1.5 | 21 | | 18 | 23.82 | 3.18 | 1.7 |
| BT40-25.4-75 | | 25.4 | 75 | 40 | M24X2 | 25 | | 21 | 27.78 | 6.35 | 2.0 |
| BT40-25.4-120 | | 25.4 | 120 | 40 | M24X2 | 25 | | 21 | 27.78 | 6.35 | 2.5 |
| BT40-31.75-90 | | 31.75 | 90 | 46 | M30X2 | 30 | | 26 | 34.92 | 34.92 | 2.6 |
| BT50-12.75-75 | | 12.75 | 75 | 20 | M12X1.25 | 15 | 5 10 20 | 12 | - | - | 3.9 |
| BT50-12.75-105 | | 12.75 | 105 | 20 | M12X1.25 | 15 | | 12 | - | - | 4.0 |
| BT50-15.875-90 | | 15.875 | 90 | 26 | M14X1.5 | 16 | | 13 | 17.42 | 3.18 | 4.0 |
| BT50-15.875-120 | | 15.875 | 120 | 26 | M14X1.5 | 16 | | 13 | 17.42 | 3.18 | 4.2 |
| BT50-22.225-90 | | 22.225 | 90 | 34 | M20X1.5 | 21 | | 18 | 23.82 | 3.18 | 4.5 |
| BT50-22.225-135 | | 22.225 | 135 | 34 | M20X1.5 | 21 | | 18 | 23.82 | 3.18 | 4.7 |
| BT50-25.4-90 | | 25.4 | 90 | 40 | M24X2 | 25 | | 21 | 27.78 | 6.35 | 4.7 |
| BT50-25.4-135 | | 25.4 | 135 | 40 | M24X2 | 25 | | 21 | 27.78 | 6.35 | 5.1 |
| BT50-31.75-90 | | 31.75 | 90 | 46 | M30X2 | 30 | | 26 | 34.92 | 7.92 | 5.1 |
| BT50-31.75-135 | | 31.75 | 135 | 46 | M30X2 | 30 | | 26 | 34.92 | 7.92 | 5.7 |
| BT50-38.1-90 | | 38.1 | 90 | 55 | M36X3 | 36 | | 31 | 42.06 | 9.52 | 5.8 |
| BT50-38.1-135 | | 38.1 | 135 | 55 | M36X3 | 36 | | 31 | 42.06 | 9.52 | 6.7 |

数控镗刀柄 BORING ARBOR

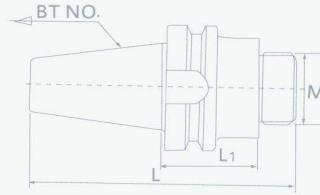
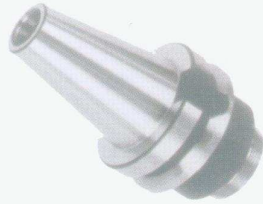

单位/Unit:mm

| 型号Model BTXM-L1 | L | 重量 Wt(kg) | 型号Model BTXM-L1 | L | 重量 Wt(kg) | 型号Model BTXM-L1 | L | 重量 Wt(kg) |
|-------------------|-------|--------------|-------------------|-------|--------------|-------------------|-------|--------------|
| BT40X7/8"-20-45 | 122.4 | 1.4 | BT50X7/8"-20-45 | 188.8 | 4.3 | BT50X1-7/8"-20-80 | 193.8 | 4.7 |
| BT40X1-1/2"-18-45 | 122.4 | 1.4 | BT50X1-1/2"-18-45 | 188.8 | 5.0 | BT50X1-1/2"-18-80 | 193.8 | 5.2 |

莫氏变径套 MORSE TAPER SLEEVE WITH TANG

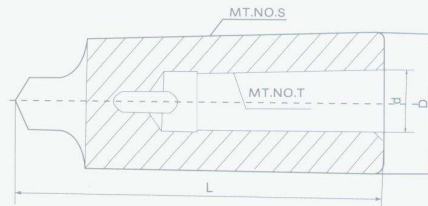

单位/Unit: mm

| 型号Model MT.NO.S-MT.NO.T | D | d | L | 重量Wt(Kg) | 精度Accuracy |
|----------------------------|------|--------|-----|----------|------------|
| 1-0 | 13 | 9.045 | 80 | 0.10 | 0.015 |
| 2-1 | 18.6 | 12.065 | 95 | 0.10 | |
| 3-1 | 24.1 | 12.065 | 99 | 0.24 | |
| 3-2 | 24.7 | 17.780 | 112 | 0.12 | |
| 4-1 | 31.6 | 12.065 | 124 | 0.60 | |
| 4-2 | 31.6 | 17.780 | 124 | 0.50 | |
| 4-3 | 32.4 | 23.825 | 140 | 0.38 | 0.02 |
| 5-1 | 44.7 | 12.065 | 156 | 1.59 | |
| 5-2 | 44.7 | 17.780 | 156 | 1.49 | |
| 5-3 | 44.7 | 23.825 | 156 | 1.36 | |
| 5-4 | 45.5 | 31.267 | 171 | 0.62 | |
| 6-1 | 63.8 | 12.065 | 218 | 3.84 | |
| 6-2 | 63.8 | 17.780 | 218 | 3.73 | |
| 6-3 | 63.8 | 23.825 | 218 | 3.50 | |
| 6-4 | 63.8 | 31.267 | 218 | 3.12 | |
| 6-5 | 63.8 | 44.399 | 218 | 1.95 | |

舌尾型莫氏钻接杆

MORSE TAPER DRILL CHUCK ARBOR WITH TANG

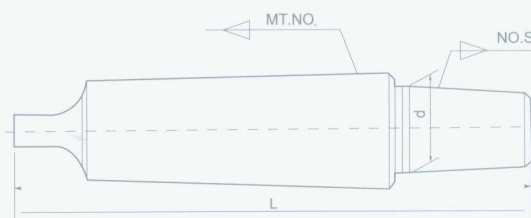

单位/Unit:mm

| 型号Model MT.NO.-NO.S | d | L | 型号Model MT.NO.-NO.S | d | L | 型号Model MT.NO.-NO.S | d | L |
|------------------------|--------|-----|------------------------|--------|-----|------------------------|--------|-----|
| MTA0-B6 | 6.350 | 75 | MTA2-B22 | 21.793 | 128 | MTA4-B18 | 17.780 | 164 |
| MTA0-B10 | 10.094 | 80 | MTA2-B24 | 23.825 | 138 | MTA4-B22 | 21.793 | 172 |
| MTA0-B12 | 12.065 | 84 | MTA2-B18S | 17.431 | 113 | MTA4-B24 | 23.825 | 182 |
| MTA0-B16 | 15.733 | 91 | MTA2-J0 | 6.35 | 94 | MTA4-J0 | 6.350 | 138 |
| MTA0-B18 | 17.780 | 99 | MTA2-J1 | 9.754 | 100 | MTA4-J1 | 9.754 | 143 |
| MTA0-B22 | 21.793 | 108 | MTA2-J2 | 14.199 | 105 | MTA4-J2 | 14.199 | 149 |
| MTA0-B24 | 23.825 | 118 | MTA2-J3 | 20.599 | 114 | MTA4-J3 | 20.599 | 158 |
| MTA0-J0 | 6.350 | 73 | MTA2-J4 | 28.55 | 125 | MTA4-J4 | 28.550 | 169 |
| MTA0-J3 | 20.599 | 93 | MTA2-J5 | 35.89 | 130 | MTA4-J5 | 35.890 | 174 |
| MTA0-J33 | 15.850 | 88 | MTA2-J6 | 17.17 | 108 | MTA4-J6 | 17.170 | 152 |
| MTA1-B10 | 10.094 | 86 | MTA2-J33 | 15.85 | 108 | MTA4-J33 | 15.850 | 152 |
| MTA1-B12 | 12.065 | 90 | MTA3-B10 | 10.094 | 120 | MTA5-B10 | 10.094 | 177 |
| MTA1-B16 | 15.733 | 97 | MTA3-B12 | 12.065 | 124 | MTA5-B12 | 12.065 | 181 |
| MTA1-B18 | 17.780 | 105 | MTA3-B16 | 15.733 | 131 | MTA5-B16 | 15.733 | 188 |
| MTA1-B22 | 21.793 | 114 | MTA3-B18 | 17.78 | 139 | MTA5-B18 | 17.780 | 196 |
| MTA1-B24 | 23.825 | 124 | MTA3-B22 | 21.793 | 147 | MTA5-B22 | 21.793 | 204 |
| MTA1-J0 | 6.350 | 79 | MTA3-B24 | 23.825 | 157 | MTA5-B24 | 23.825 | 214 |
| MTA1-J1 | 9.754 | 85 | MTA3-J0 | 6.35 | 113 | MTA5-J0 | 6.350 | 170 |
| MTA1-J2 | 14.199 | 90 | MTA3-J1 | 9.754 | 118 | MTA5-J1 | 9.754 | 175 |
| MTA1-J3 | 20.599 | 99 | MTA3-J2 | 14.199 | 124 | MTA5-J2 | 14.199 | 181 |
| MTA1-J4 | 28.550 | 110 | MTA3-J3 | 20.599 | 133 | MTA5-J3 | 20.599 | 190 |
| MTA1-J5 | 35.890 | 116 | MTA3-J4 | 28.55 | 144 | MTA5-J4 | 28.550 | 201 |
| MTA1-J6 | 17.170 | 94 | MTA3-J5 | 35.89 | 149 | MTA5-J5 | 35.890 | 206 |
| MTA1-J33 | 15.850 | 94 | MTA3-J6 | 17.17 | 127 | MTA5-J6 | 17.170 | 184 |
| MTA2-B10 | 10.094 | 101 | MTA3-J33 | 15.85 | 127 | MTA5-J33 | 15.850 | 184 |
| MTA2-B12 | 12.065 | 105 | MTA4-B10 | 10.094 | 145 | MTA6-J6 | 17.170 | 246 |
| MTA2-B16 | 15.733 | 112 | MTA4-B12 | 12.065 | 149 | | | |
| MTA2-B18 | 17.780 | 120 | MTA4-B16 | 15.733 | 156 | | | |



Weifang Wilda Machinery Co.,Ltd.

Address: Ze Er Zhuang Industrial Zone, Wei Zhou Lu Bei Duan,
Weifang, Shandong, P.R.China.

Tel:(86)-536-8651769, Fax:(86)-536-8668039

Mobile: 0139 5360 6679 / 0135 0649 6031

E-mail:wilda@public.wfptt.sd.cn / victwang@hotmail.com